

Entrance sign

Projecting sign, Vista Square series

Vista Square's flag sign is designed to accept standard size flat extrusions to create a double-sided well noticeable way-finding element. The smart design allows for an easy installation and removal of the sign for painting or other maintenance.



Dimensions:

Vista Square sign frames are offered in 9 different widths:

3.86", 4.64", 5.83", 7.8", 8.27", 8.5", 11", 11.69", 15.59"

(F100, F120, F150, F200, FA4, F-Letter, F11, F300, F400 (mm))

Length: 4.75"-16" (120 mm – 406 mm)

Custom lengths are available.

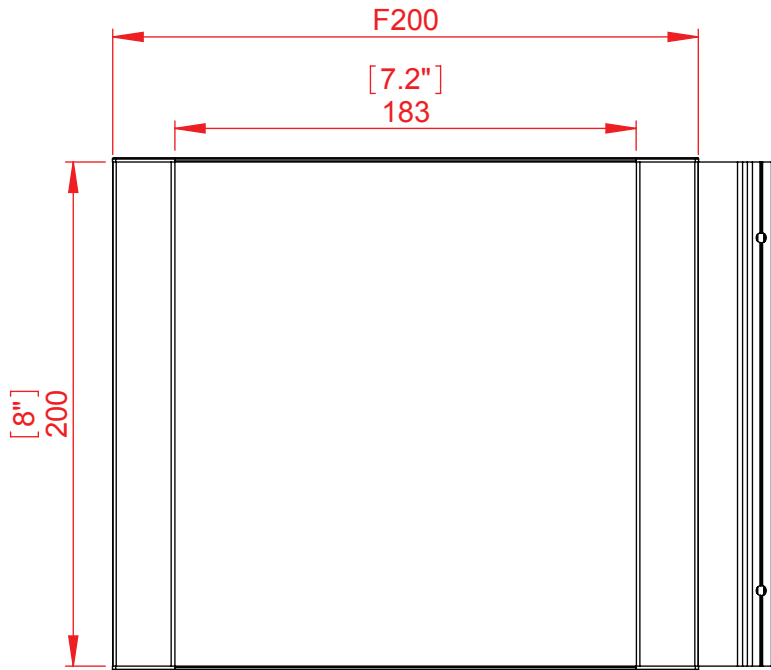

Side view

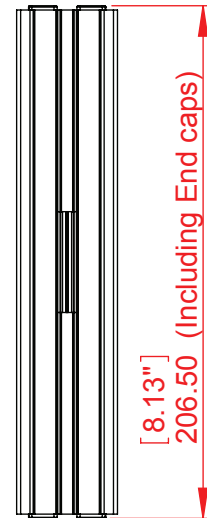

Front view

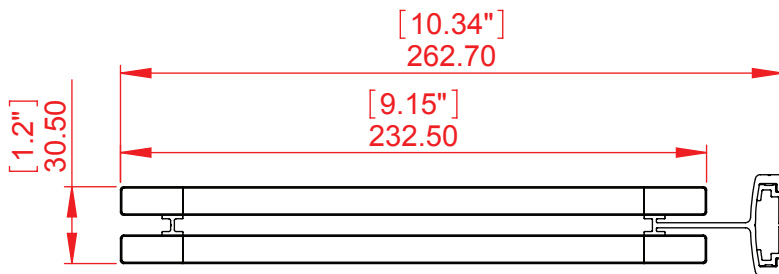

Top view

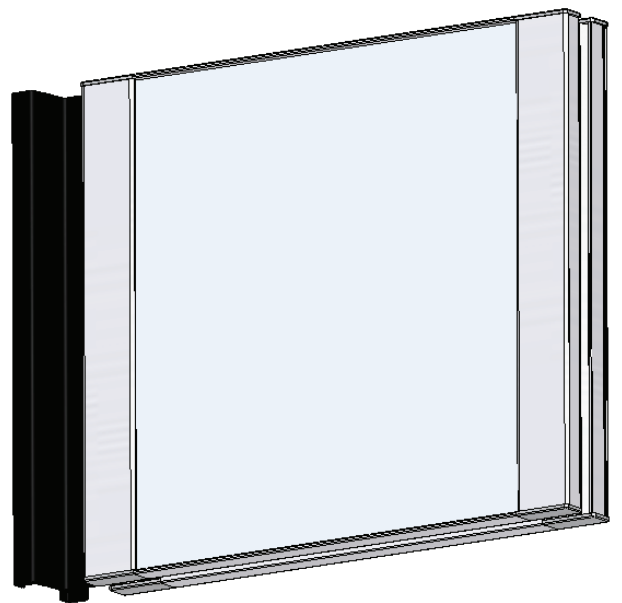

Isometric view



Project		Designer: R.C
Model	Flag sign F200x200	Date: 25/06/2015
Part Number	FSF7 / FSF7U	Scale:
Material		Measurements in millimeters Do not scale drawing

Proprietary and confidential: The information contained in this drawing is the sole property of Vista system Limited. Any reproduction; copying; distribution or any other use in part or as a whole without the written permission of Vista system Limited is prohibited. This ban includes any use by any third party that did not receive this information from Vista system Limited.